



(Tapered Type)



(Diamond Type)



(Straight Type)

Body
SCM440 steel
Quenched & tempered
Black oxide finish
Precision ground

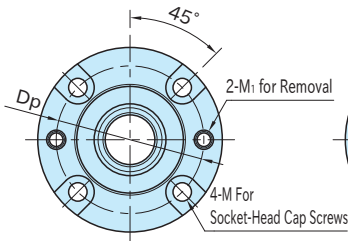
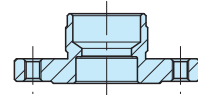
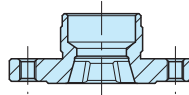
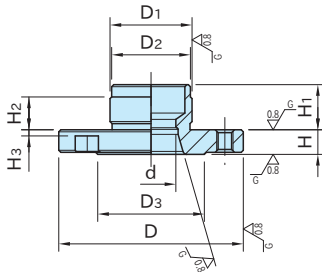

**AMWF-BU-T**  
(Tapered Type)

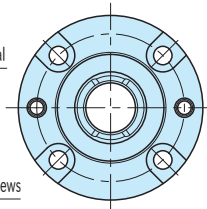

**AMWF-BU-D**  
(Diamond Type)

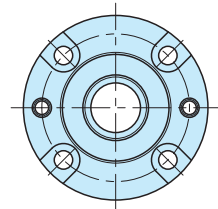

**AMWF-BU-S**  
(Straight Type)

Type		D <sub>1</sub> (g6)	H <sub>2</sub>	D <sub>2</sub>	H <sub>1</sub>	M	H <sub>3</sub>	D	D <sub>3</sub>	H (±0.003)	d (+0.15 +0.05)	M <sub>1</sub>	D <sub>p</sub>
<b>AMWF-BU-T</b>	<b>40</b>	28	10	27.5	15	M5	2.5	60	38	8	16	M5×0.8	50
<b>AMWF-BU-D</b>													
<b>AMWF-BU-S</b>	<b>50</b>	36	14	35.5	19	M6	3.5	75	48	10	20	M6×1	62

**AMWF-BU-T** (Tapered Type)

Part Number	Weight (g)
AMWF40-BU-T	160
AMWF50-BU-T	323

**AMWF-BU-D** (Diamond Type)

Part Number	Weight (g)
AMWF40-BU-D	159
AMWF50-BU-D	322

**AMWF-BU-S** (Straight Type)

Part Number	Weight (g)
AMWF40-BU-S	163
AMWF50-BU-S	330

**Feature****Function**

Locating with Tapered Type  
For setting reference position

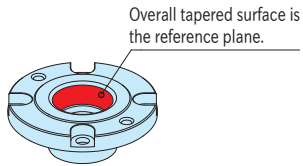

Locating with Diamond Type  
For locating reference at rotational direction

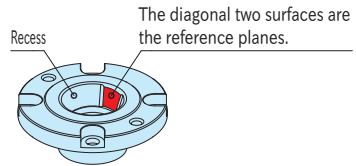

Clamping with Straight Type

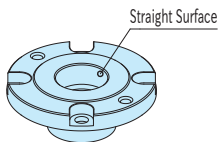
**Related Product**

**AMWF-W** PNEUMATIC FLEX LOCATOR PINS

**Reference**

- How To Use PNEUMATIC FLEX LOCATORS
- How To Install PNEUMATIC FLEX LOCATORS