

Manual Tilting type

THNC THNC-251•301





Manual tilt adjustment type with a highly rigid body and a powerful hydraulic clamp system.



THNC-251

Specifications

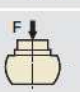
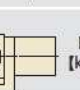
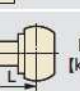
Unit: mm

		THNC-251		THNC-301	
Tilt range		0° ~ +93°		0° ~ +93°	
Table diameter*1		φ250		φ320	
Table height at 0° position		230		265	
Center height at 90° position		210		235	
Center bore	Nose diameter	φ40H7		φ40H7	
	Through-bore	φ32		φ40	
Table T-slot width*1		12H7		14H7	
Guide block width		18h7		18h7	
Servo motors (for FANUC)	Rotary axis	αiF4	Tilt axis	Rotary axis	Tilt axis
			Manual	αiF8	Manual
Inertia converted into motor shaft	$\times 10^{-3} \text{kg} \cdot \text{m}^2$	0.20	—	0.25	—
	$[\times 10^{-3} \text{kgf} \cdot \text{cm} \cdot \text{sec}^2]$	[2.0]		[2.6]	
Speed reduction ratio		1/180	—	1/180	—
Table max. rpm	min ⁻¹	11.1	—	11.1	—
	(Motor rpm: 2,000min ⁻¹)				
Clamp system	Supplied pressure	Hydraulic 3.5MPa [35kgf/cm ²]	Manual 19.6N·m [2kgf·m]	Hydraulic 3.5MPa [35kgf/cm ²]	Manual 35.3N·m [3.6kgf·m]
	Clamp torque	N·m [kgf·m]	490 [50]	490 [50]	833 [85]
Indexing accuracy(the sum)	sec	15	60	15	60
Net weight	kg	125		180	
Strength of worm gears (Rotary axis)	N·m [kgf·m]	470 [48]		764 [78]	
Allowable work weight	0° (Horizontal)	 kg	80	200	
	0° ~ 90° (Tilting)	 kg	40	100	
Allowable load (when table is clamped)	F	 N [kgf]	6,860 [700]	9,800 [1,000]	
	FxL	 N·m [kgf·m]	490 [50]	833 [85]	
	FxL	 N·m [kgf·m]	490 [50]	1,862 [190]	
Allowable work inertia	$J = \frac{W \cdot D^2}{8}$	 $\text{kg} \cdot \text{m}^2$ [kgf·cm·sec ²]	0.62 [6.3]	2.25 [23]	

☞ Servo motors of other manufacturers **P.66**

* 1 The tolerance of the table T-slot width is applicable to four standard slots arranged crosswise. ☞ Dimensions **P.60**

Dimensions

Unit: mm

THNC-251

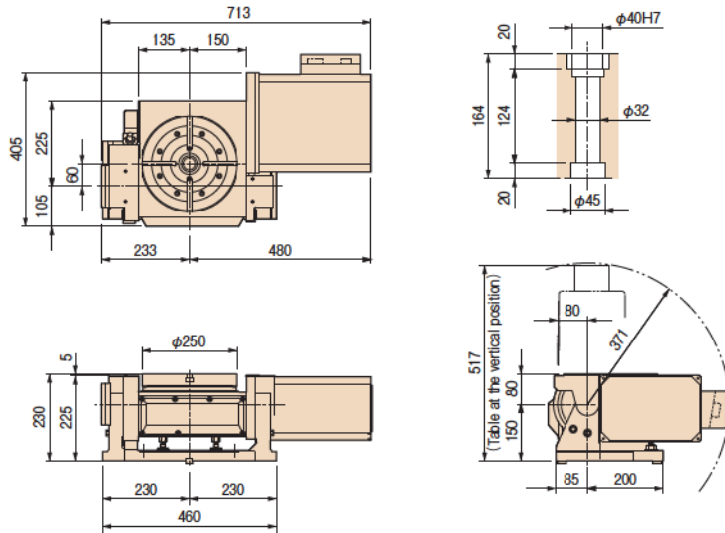

THNC-301

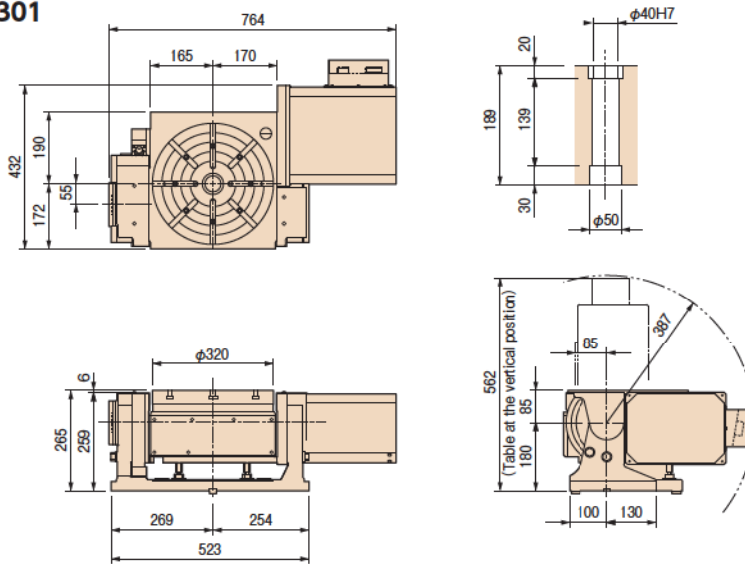

Note: The above dimensions are for FANUC servo motors. The dimensions of servo motors of other manufacturers may be larger.

RBS

TBS

RWE/RWA
RN

RWE/RWA-B
RNCV-B

RNCM

RWB

RWB-K
RNCK

RCH
RNC

RCV
RNCV

Multi-Spindle
RWM

TWA/TN

TTNC

THNC

Multi-Spindle
TWM

RDS

RTV
RTT

RCB

NC Controllers

Accessories

Options

Technical
Information

Clamping block and bolt

Unit: mm

	Type	Q'ty	Layout	T-slot pitch	T-slot width	A	B	C	D	E	F	G	H	I	J	K	L	M
THNC-251	I	4	a b	40~100 40~65	18	25	12	80	12	33	35	22	21	11	65	40	28	16
THNC-301	II	4	a b	40~130 40~80	18	25	15	52	12	15	25	40	21	11	85	40	28	16

Note: When using a machine with a T-slot pitch other than the above, use suitable clamping blocks and bolts that are available on the market, or order custom-made ones from TSUDAKOMA. (Option)

